DogWatch DIY Hidden Fence System

Owner's Guide



Thank You for Purchasing a DogWatch® Hidden Fence!

Thank you for choosing DogWatch to help protect what matters most — your pet. For over 35 years, DogWatch has been dedicated to putting pet safety first, designing reliable containment and training products that give families peace of mind and pets the freedom to explore safely. Every DogWatch system is built with care, tested for reliability, and backed by a team that truly cares about your pet's safety, comfort, and well-being. We're honored to be part of your pet's life and grateful for the trust you've placed in DogWatch.

What's In the Box



1 DogWatch
Transmitter



1 DogWatch
Receiver &
Collar Strap



15' Zip
Clip Wire



60'
Twisted
Wire



1 Surge
Protector



100
Boundary
Flags



500'
Boundary
Cable



Splice
Nuts



1 Receiver
Multi-Tool



1 Training
Leash

Required Tools & Materials

Having these tools ready before you begin will help ensure a smooth and efficient DogWatch installation.

- Power drill
- 3/8" drill bit
- Phillips head screwdriver
- Measuring tape
- Wire cutters / wire strippers
- Trenching tools for burying twisted & boundary wire (shovels, edger, trencher, etc.)
- Outdoor-rated caulk
- Driveway caulk
- Staple gun with staples or wire clips
- Safety glasses and work gloves

TABLE OF CONTENTS

1. How it Works	2
2. Your Fence Layout	3
3. Installing LP-10 Surge Protector	5
4. Boundary Wire Instructions	6
5. Crossing a Driveway or Walkway	8
6. DogWatch Transmitter Features and Settings	9
7. DogWatch Receiver Collar Features	10
8. Pet-Friendly™ Containment Training	13
9. Troubleshooting	18
10. Terms and Conditions	19

1. HOW IT WORKS

The fence is created by burying a wire in your yard.

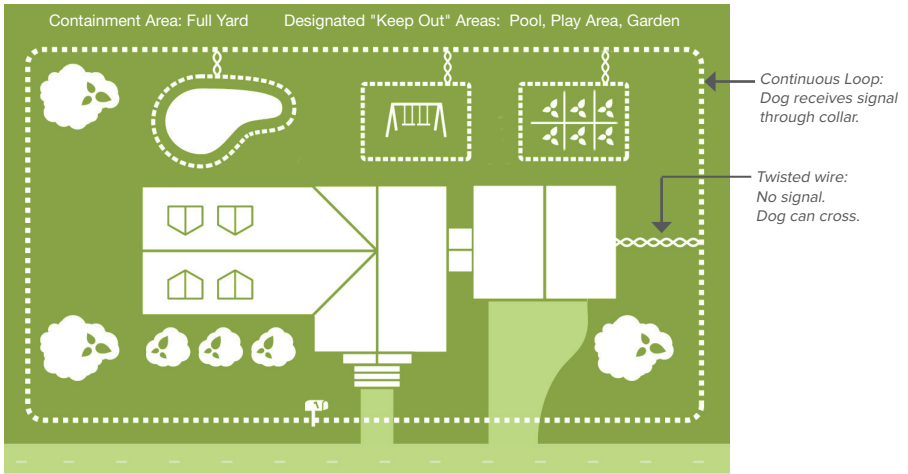

The Hidden Fence Transmitter sends a **coded digital FM radio signal** through a wire buried in your yard (the boundary wire). The wire should be buried 3-4" beneath the surface of the yard or can lie on top of the ground (e.g. in wooded or rocky areas.) **It is not electrified**, so it can also be installed in water (streams, in lakes, etc.)

To work properly, the boundary wire must form a **continuous loop**. A **twisted wire cancels the signal** and can be used in locations where you want the dog to be able to cross the wire without receiving a warning signal or correction, such as where the wire travels from the house to the boundary perimeter.

Signal Field

The signal field is typically set at 3 to 6 feet (each side of the wire) but can be set from 1 to 10 feet (each side). The signal field is adjusted by the Range Control on the Transmitter.

The radio signal is transmitted equidistant from the boundary wire in ALL directions.

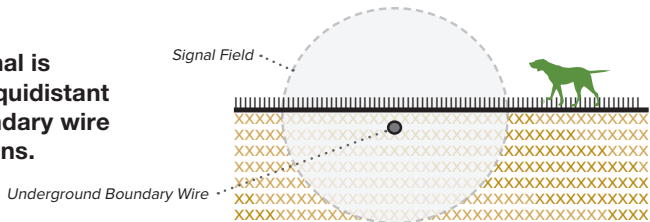

2. YOUR FENCE LAYOUT

Yard Configurations

3. Double Loop: This is used to contain your pet in one portion of the yard.

- When doing a “double loop” leave a minimum of 4 ft between the boundary wires to prevent signal canceling.

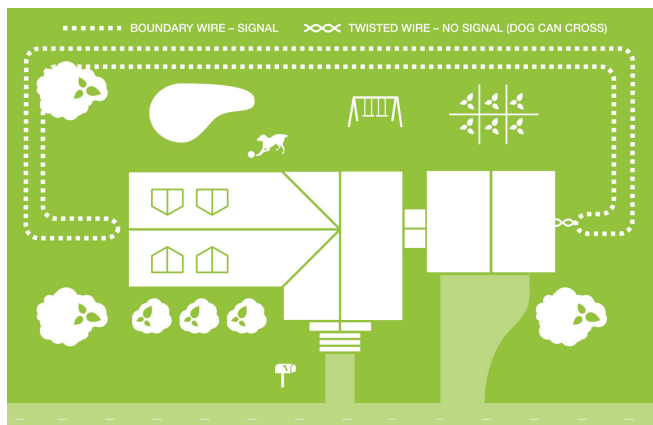

4. Exclusion Areas: DogWatch boundary wire can also be used to create exclusion zones around gardens, pools, play areas, or other off-limits spaces within the yard. These zones keep your dog away from specific areas while maintaining access to the rest of the yard.

Choosing the right yard configuration helps ensure your DogWatch system delivers safe, effective containment tailored to your property.

3. INSTALLING LP-10 SURGE PROTECTOR

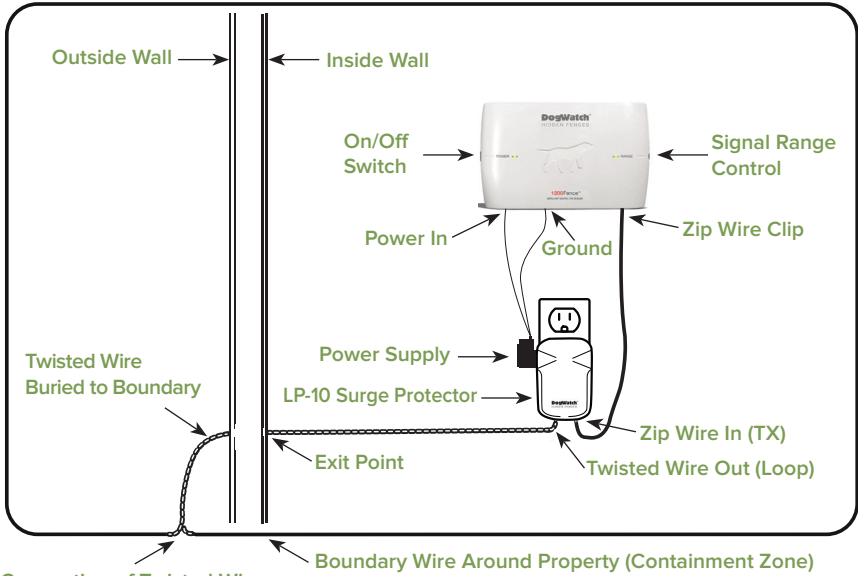

Connection of Twisted Wire to Boundary Wire

Transmitter Location

- Find a location that is indoors, dry, and within 8 feet from an electrical outlet.
- Use template to mark the location of the transmitter mounting screws
 1. Plug LP-10 Surge Protector into Power Outlet
 2. Separate the end of the Zip wire and Strip 1/4" off the end exposing the copper core
 3. Connect the wires to the Transmitter ("TX") terminals
 4. Separate the ends of the twisted wire and Strip 1/4" off the end exposing the copper core
 5. Connect the twisted wire to the "Loop" terminals



4. BOUNDARY WIRE INSTRUCTIONS

Exiting the Boundary Wire from the House

***Twisted wire will exit the home through a 3/8" drilled hole.**

The boundary wire must exit the building to connect to the outdoor fence loop. Follow these steps to safely route the wire outside.

1. Choose an exit point location near the LP-10 Surge Protector where the wire can exit directly to the yard. Common exit points include rim joists, foundation walls, or garage walls. Avoid drilling near electrical wiring, plumbing, or gas lines.
2. Drill the 3/8" exit hole for the twisted wire to pass through. Angle the hole slightly downward toward the outside to help prevent moisture from entering.
3. Feed the twisted wire through the hole, leaving enough slack inside to comfortably reach the DogWatch surge protector and transmitter terminals. Avoid sharp bends or pulling the wire tight.
4. Seal the opening around the twisted wire on both the interior and exterior using outdoor-rated caulk. This helps protect the wire and prevents moisture, insects, and drafts from entering the building.
5. Secure the DogWatch twisted wire along the wall using insulated staples. Do not pierce, pinch, or crush the wire, as this may affect system performance.
6. Strip 1/4" from the twisted wire that inside. Connect twisted wire to surge protector on the "LOOP" terminals.

Once the wire is outside, you can continue installing the DogWatch boundary wire around your property.

- 1/2" conduit can be used to protect exposed wire on exterior of home or shallow locations.

Installing the Twisted Wire

The twisted wire is used to carry the signal from the transmitter to the start of the boundary without creating a correction field.

- 1. Identify the Twisted Wire Path:** Use twisted wire from the surge protector to the point where the boundary wire begins
- 2. Lay the Wire:** Route and lay the twisted wire on the ground. Avoid sharp edges, moving parts, or areas where the wire could be damaged.
- 3. Connect to the Boundary Loop:** At the start of the fence loop, separate the twisted wires and connect each wire to each side of the boundary wire using the two splice nuts. Make sure all connections are tight and secure.

Properly-installed twisted wire allows the DogWatch system to deliver precise containment only where you want it.

4. BOUNDARY WIRE INSTRUCTIONS

Installing the DogWatch Boundary Wire

The DogWatch boundary wire creates the containment area that keeps your dog safely within your property. Take time to plan your layout before installing.

**It is important to have utilities and underground wires marked before you dig and bury your wires. (These are usually free through services like "811".)*

The boundary wire must be a continuous loop, starting and stopping at the same location.

- 1. Plan the Boundary Layout:** Walk your property and plan where the DogWatch boundary wire will be installed. Keep the wire a safe distance from roads, sidewalks, and neighboring properties. Avoid placing the wire near large metal objects, underground utilities, or existing electric lines.
- 2. Lay Out the Wire:** Starting at the end of the twisted wire, lay the DogWatch boundary wire on the ground following your planned layout. Create smooth corners rather than sharp angles to ensure consistent signal coverage.
- 3. Bury Wire:** Bury or Secure the Wire 1–3 inches below the surface using a shovel or trenching tool. In areas where burial is not possible, secure the wire along fences, walls, or hardscape using landscape staples. Do not staple through the wire.
- 4. Maintain Wire Spacing:** If boundary wires run close together, maintain proper spacing as outlined in your DogWatch layout guidelines (see pages 3-4).
- 5. Complete the Loop:** Go back to the twisted wire to complete the loop. Power on the DogWatch Transmitter and confirm the boundary is complete by verifying there is no break alarm. Then complete the final burial of the boundary wire.
- 6. Tie Wires:** Tie the connected twisted wires and boundary wires into a knot to provide stress relief for your boundary loop.

A properly installed boundary wire ensures consistent containment and reliable performance from your DogWatch system.

Do not connect all of the four wires together.

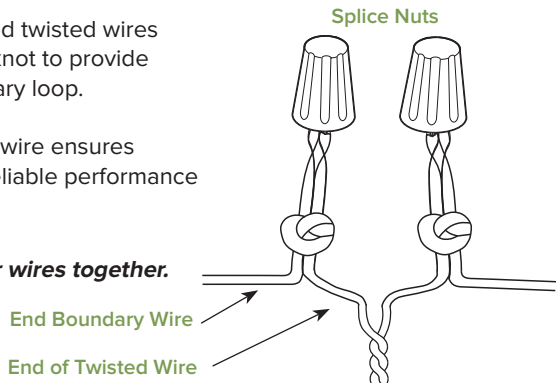

5. CROSSING A DRIVEWAY OR WALKWAY

If your DogWatch boundary layout requires the wire to cross a driveway or stone walkway, it should be installed in a protected groove to prevent damage and ensure long-term reliability.

1. Choose a straight section of the driveway for the wire crossing and mark the location using chalk.
2. Cut a ¼-½ inch shallow groove across the driveway surface using a power saw equipped with a diamond blade.
3. Install the boundary wire into the groove, keeping it flat and free of sharp bends. Ensure the wire sits fully below the driveway surface to protect it from vehicle traffic.
4. Seal the groove with an outdoor-rated driveway caulk to secure and protect the DogWatch boundary wire from moisture and wear.

For concrete driveways, an existing expansion joint can be used.

For gravel driveways, it is recommended to secure the boundary wire in conduit.

Properly installing the boundary wire across a driveway ensures reliable containment and long-term protection of your DogWatch Fence system.



6. DOGWATCH TRANSMITTER FEATURES & SETTINGS

The Transmitter's coded digital FM radio signal can be adjusted, allowing you to control the settings of the Hidden Fence around your property

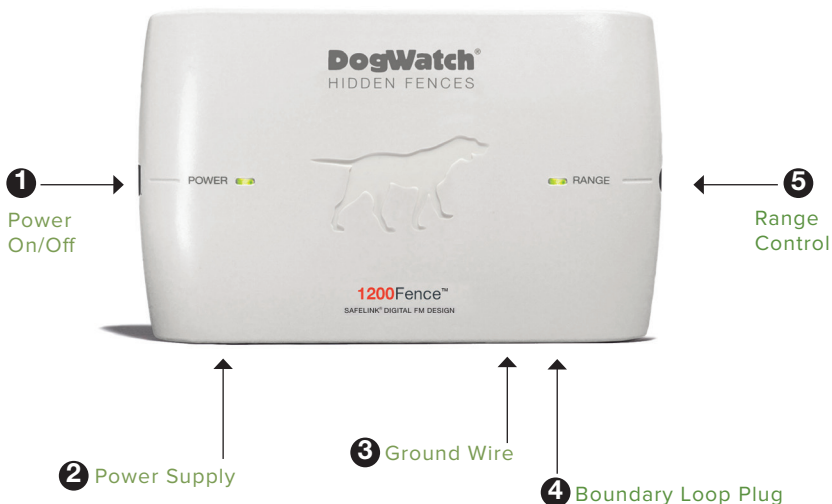

Never adjust the transmitter while your dog is wearing the receiver collar.

- 1. Power On/Off:** This switch gives you easy access to turn the transmitter 'ON' or 'OFF'. The power light on the front panel lets you know that it is operating properly.
- 2. Power Supply:** The transmitter is powered by the power supply/adaptor provided with the transmitter. The power supply is plugged into a properly grounded 110 volt outlet and the adapter is plugged into the "PWR" jack on the bottom of the transmitter.
- 3. Ground Wire:** The green ground wire connects to the transmitter at the location labeled "GND." The wire is grounded through your power supply. It will, however, only be effective if your outlet is properly grounded. If you have any questions about having a properly grounded outlet, consult your local electrician.
- 4. Boundary Loop Plug:** Your system includes a zip cord with a plug on one end. This plug fits into the hole marked "Loop" on the bottom of the transmitter. This is the beginning of the boundary wire that is buried in your yard.
- 5. Range Control:** The radio signal is transmitted from the boundary wire in all directions. The signal range (the distance the signal broadcasts from the wire) is adjusted by the Range Control on the transmitter. The recommended signal range (on each side of the wire) is 6-10 feet.

Proper configuration of the DogWatch transmitter and receiver collar ensures safe, consistent, and effective containment for your dog.

7. DOGWATCH RECEIVER COLLAR FEATURES

R12mini and R12 Receiver

The components of both the R12mini and the R12 are the same except the R12mini is smaller and uses a different battery.

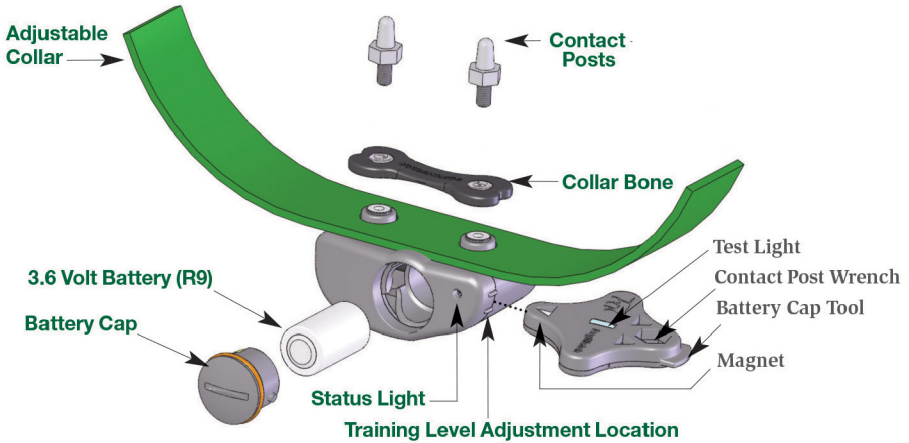

Receiver Battery

The R12mini and R12 operate on a replaceable battery. Both receivers are waterproof when the battery cap is fully seated.

R12mini Battery: The R12mini receiver is powered by a 3 volt (1/3 N) lithium battery. With normal use, the battery should last about six months. The negative (-) end of the battery must be inserted down. (Figure 1)

R12 Battery: The R12 receiver is powered by a 3.6 volt lithium battery. With normal use, the battery should last about two years. The positive (+) end of the battery must be inserted down. (Figure 2)

Figure 1

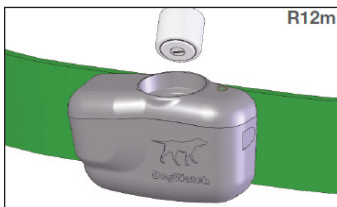

R12mini: Insert battery negative end down.

Figure 2

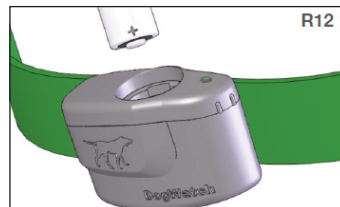

R12: Insert battery positive end down.

Resetting the Battery Status Light

1. Remove the old battery.
2. Before inserting a new battery, let the receiver sit for five minutes before inserting a new battery. If you forget to wait prior to inserting a new battery, the flashing red battery status light will continue to flash for 24 hours before automatically resetting.
3. After five minutes, insert a new battery.

7. DOGWATCH RECEIVER COLLAR FEATURES

Receiver Status Light

The status light continuously monitors your receiver and provides these features:

- **Start-Up** When you first insert the battery into the receiver, the status light will flash red and green. This indicates that the receiver has started properly. Once started, the status light will continue to flash green once every 40 seconds indicating normal operation. In the event that the light does not flash, check the battery to be sure that it has been inserted properly.
- **Training Level Indicator** When programming the training level of your receiver, the status light will flash green in conjunction with audible beeps. The number of flashes/beeps will equal the Training Level you have chosen (see chart below).
- **Signal Field Indicator** When testing the receiver in the signal field the status light will flash green when the receiver is in the warning zone and will flash green and red when the receiver is in the correction zone.
- **Battery Indicator** This feature monitors the voltage level of the battery. When the receiver detects that the battery has reached a low voltage level, the status light will change from the normal blinking “green” every 40 seconds to blinking “red” every 10 seconds. This indicates that your battery is close to the end of its useful life and you should change the battery within the next 3-4 days.



R12mini Status Light

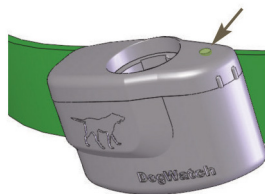

R12 Status Light

Setting the Receiver

Receiver Training Levels Your receiver provides 4 training levels plus an audible only setting. Level 1 is a very low correction setting that may be an appropriate training level for timid pets. Levels 2 and 3 are progressively stronger training levels. Level 4 is designed for pets that require higher correction levels in order to be contained. Select the appropriate level for your pet, always starting at the lowest training level.

Changing the Receiver Settings If you need to change the Training Level on the receiver, hold your Multi-Tool magnet to the marked area on the side of the receiver (as shown on page 12). Hold the magnet steady and you will hear a series of beeps that indicate the current training level. The “Audible Only” level is one long beep, Level 1 is one short beep, Level 2 is two short beeps, Level 3 is three short beeps, etc. The Training Level will continue to advance while the magnet is held in position. When you reach the desired setting, pull the magnet away from the receiver. The receiver is now set.

Training Level	Audible Only	Level 1	Level 2	Level 3	Level 4
Tone	One Long Beep	1 Beep	2 Beeps	3 Beeps	4 Beeps
Correction Level	None	Low	Medium	Medium-High	High

*** IMPORTANT ***

Never change the receiver Training Levels when your dog is wearing the collar.

7. DOGWATCH RECEIVER COLLAR FEATURES

Setting and Changing the Training Level

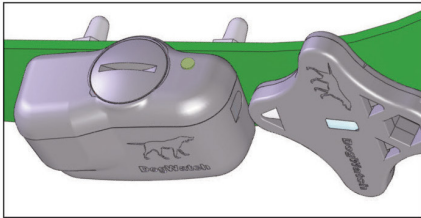

R12mini

Hold the magnet between the two lines on the side of the receiver to set the training level.

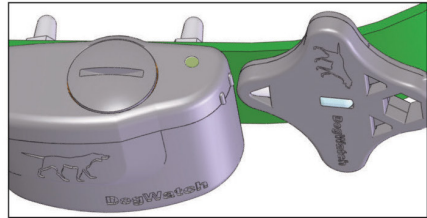

R12

Hold the magnet between the two lines on the side of the receiver to set the training level.

Multiple Pets: Your DogWatch system works with multiple receivers set at different Training Levels. If you have more than one pet, each receiver can be set to the level that is most appropriate for that pet.

TESTING THE RECEIVER

To test the receiver, hold the Multi-tool over the contact posts and carry the receiver into the signal field. When the receiver detects the signal from the boundary wire, the audible warning will sound and the Multi-Tool test light will illuminate.

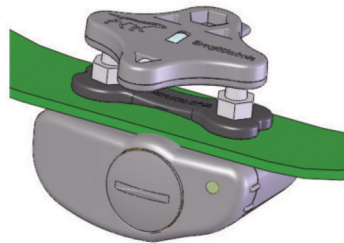

FITTING THE RECEIVER COLLAR

The receiver is attached to an adjustable nylon collar. The collar should be positioned above the dog's regular collar. Adjust the collar to make sure the contact posts touch the skin on the dog's neck. Check the fit for the first few days to make sure that the collar is not too tight. It is recommended that you remove the collar at night to help prevent skin irritation.

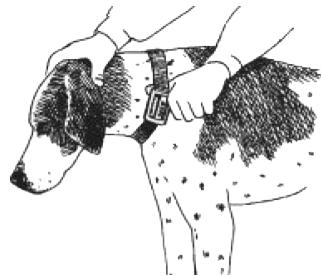

Note: Tighten the contact posts only with the collar wrench of the Multi-Tool provided. Use of pliers or similar tools can damage the receiver.

8. PET-FRIENDLY™ CONTAINMENT TRAINING

1 PHASE 1 (1-2 days) Audible “Beep” Training

During this phase, the Training Level on the receiver is set to “Audible Only”. On this setting, your dog will hear only the audible “beep” tone and will not receive a correction if he enters the Avoidance Zone.

1. Put the receiver collar on your dog 20 minutes before training. Your dog’s regular collar should be positioned below the DogWatch collar.
2. Clip the green DogWatch training leash on his regular collar.
3. Take your dog outside and play with him in the Safety Zone for a few minutes.
4. Walk your dog around the perimeter of your yard, keeping inside the Safety Zone and away (about 3 to 4 feet) from the training flags.
5. When you finish the walk, approach a training flag. Hold the dog by the leash in one hand and slap or shake a flag with the other, warning the dog firmly (in a low stern voice) “Watch out!” or “Careful!” You can also use a friend or family member to sit in the Avoidance Zone to shake the flag as you approach it.
6. Give the leash a firm tug, and quickly retreat into the Safety Zone. This creates a sense of urgency to the retreat. It is not a casual turn. Remember to use a lot of “Good dog!” praise after you’ve retreated into the Safety Zone.
7. Now walk your dog around the property allowing him to enter the Avoidance Zone between the two flags.
8. When your dog enters the Avoidance Zone, he will receive an audible “beep” (or vibration) warning. Immediately say, “Watch out!” and quickly tug on the leash and direct him back into the Safety Zone and praise.
9. Repeat several times in different locations (where flags are visible) and watch for hesitation as you approach the flags. Your dog may turn or shake his head when he hears the beep (or feels the vibration).



Give a verbal warning at the flags, “No.”

Remember: Playtime is very important! Praise and play with your dog in the Safety Zone for a few minutes. Take your dog inside and remove the receiver collar after about 20 minutes. Train your dog in this manner for a least two days before moving on to Phase 2.

8. PET-FRIENDLY™ CONTAINMENT TRAINING

2 PHASE 2 (2-5 days) Introduction to Correction

1. Put the DogWatch receiver collar on your dog at least 20 minutes before going outside to train.
2. Clip on the green DogWatch training leash to your dog's regular collar and take your dog outside and play a few minutes in the Safety Zone.
3. Walk around the complete perimeter, remaining inside the Safety Zone. Pause a few times along the way to slap a flag and say, "No!"

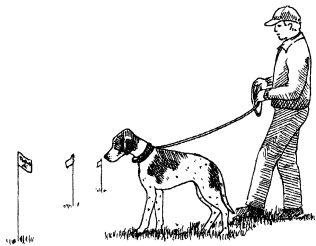

Give one tug and warning at the flags, "No."

4. Now you are ready to introduce your dog to correction. Phase Two will help reinforce your dog's new boundary and the consequences if he crosses the training flags. Select a new location to teach your dog today. Allow your dog to walk into the Avoidance Zone while saying the negative command. When your dog retreats out of the Avoidance Zone after he hears the warning "beep", praise him for a few minutes in the Safety Zone. Select another location and repeat the exercise. If your dog does not react to the correction, first check to be sure the contact posts are touching the dog's skin. Always start at the lowest level of correction and work your way up one level at a time as necessary.
5. After training, praise your dog and play with him in the Safety Zone for a few minutes. Then bring your dog into the house and remove the receiver collar after about 20 minutes.

Note: Do not remove the receiver collar immediately following the training so your dog does not associate the collar with the correction.

Remember: Training sessions should last no longer than 15-20 minutes each, and no more than twice a day.

8. PET-FRIENDLY™ CONTAINMENT TRAINING

3 PHASE 3 (2-5 days) Introduction to Distractions

1. Put the receiver collar on your dog at least 20 minutes before going outside.
2. Clip on the green DogWatch training leash to your dog's regular collar and take your dog outside and play a few minutes in the Safety Zone.
3. Walk around the Safety Zone and have an assistant (friend or family member) appear outside the Safety Zone at least 10 to 15 feet back from the flags. Walk past your assistant without speaking, but remain in the Safety Zone.

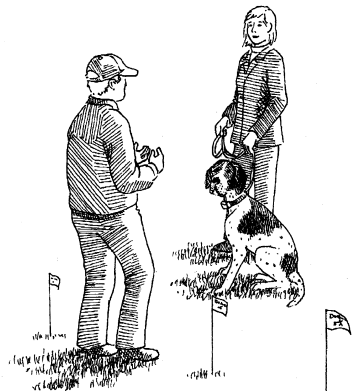

Ask someone to be a distraction.

4. If your dog approaches your assistant and enters the Avoidance Zone, allow your dog to receive a correction. Say, "Watch out!" and tug him back into the Safety Zone.
5. Let your assistant leave, walk your dog around the perimeter again, and let your assistant appear again. Your assistant can call out the dog's name, but do not allow your assistant to ask the dog to "Come".
6. If your dog attempts to go over to your assistant, reinforce the flags and say, "No!" Repeat the exercise for no more than a total of 20 minutes.
7. If your dog makes no attempt to go over to your assistant, reinforce the flags, end the exercise and praise your dog in the Safety Zone.
8. Repeat the exercise for 2 to 5 days. Then move to Phase 4.

8. PET-FRIENDLY™ CONTAINMENT TRAINING

4 PHASE 4 (2-5 days) Introduction to Increased Distractions

1. Put the receiver collar on your dog at least 20 minutes before going outside to train.
2. Clip on the green DogWatch training leash to your dog's regular collar and take him outside. Play a few minutes in the Safety Zone.
3. Reinforce the flags.
4. Introduce "real life" distractions to your dog. Have a friend drop by or start training when the letter carrier or school bus is scheduled. Take extra care if you use a vehicle as a distraction.
5. Keep the dog on the leash when you first introduce the distraction. If your dog attempts to run past the flags and receives a correction, he should retreat to the Safety Zone. Praise and play with your dog.
6. If your dog retreats to the Safety Zone, drop the leash (but keep it within reach) and reintroduce the distraction. Praise and Play.
7. If your dog is afraid to move, gently pull him back into the Safety Zone. Continue to train with distractions for 2-5 days.

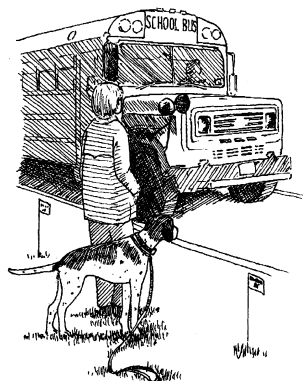

Introduce a distraction.

Remember: Play and praise at the end of each training session.

5 PHASE 5 (2-5 days) Letting Your Dog Off the Leash

1. Put the receiver collar on your dog at least 20 minutes before going outside to train.
2. Clip on the green DogWatch training leash to your dog's regular collar and take him outside and play a few minutes in the Safety Zone. Remove the training leash and let him run freely in the yard. Shake the flags to reinforce where his boundary is
3. **Important:** Your dog will expand his comfort level over a period of time. Your dog should remain about 6 feet away from the flags when he is first let off the leash. Gradually your dog's safety zone will increase to his individual level of comfort. Remove the yard flags, every other one, every other day.

8. PET-FRIENDLY™ CONTAINMENT TRAINING

What To Expect Off The Leash

1. Your dog will run toward the flags, see them and stop.
2. Your dog will run into the Avoidance Zone, hear the “beep” warning and retreat.
3. Your dog will run into the Avoidance Zone, hear the “beep” warning, receive a correction, and retreat.
- 4 In rare cases, your dog may run through the boundary.
 - Retrieve the dog immediately. Take off the receiver collar and walk him back into the yard.
 - Bring the dog into the house and remove the receiver collar after about 20 minutes.
 - Additional flag training or an increase in correction level is necessary at this point. Remember, always work your way up one level at a time as necessary.
 - **Important:** Do not punish the dog verbally for making errors. He’s still learning!

6

PHASE 6 (2-5 days) Taking Your Dog Outside the Boundary

Two to five days after you complete Phase 4, begin the last phase of training: taking your dog across the boundary for a walk. It is important to be consistent when taking your dog for a walk. Be sure to use your dog’s regular collar and leash and go to and from your walk using the same “exit” area. You can also pick up a small dog and carry him over the flagged boundary during the first weeks of training.

Final Exam Day!

Play in the Safe Zone. Try tossing a ball outside of the boundary (but DO NOT throw it in the street). If your dog does not cross the boundary to get the ball, he passes the test! If he does cross the boundary, go back to Phase 3 and repeat the training until he can pass this last test.

9. TROUBLESHOOTING

Is your Transmitter beeping?

If the boundary loop wire is broken or the signal is interrupted, an audible warning will sound. You should check around your property for a visible wire break.

No lights on your Transmitter?

Check transmitter power supply is fully connected.

No response from your Receiver?

Verify receiver is blinking green. If not, replace battery.

Is your pet not staying within the boundary?

Check the following:

- Does the battery in the receiver collar need to be replaced?
- Is the receiver collar too loose?
- Is the receiver collar operating properly?
- Is the Transmitter on and adjusted properly?
- Is the signal field too narrow?
- Is the Rate level too low?
- Is the Training Mode switch in the proper position?
- Is the boundary wire unplugged?
- Is the boundary wire broken?

Important Safeguards and Reminders

- Never adjust the Transmitter while your dog is wearing the receiver collar.
- If you adjust the SIGNAL RANGE on the Transmitter, be sure you check the signal range in the yard before letting your dog out. Your dog will need to learn where the new avoidance zone begins.
- Keep the Transmitter and receiver collar out of reach of children.
- Be sure your Transmitter and surge protector are properly grounded.
- Fit the collar snugly around your dog's neck. It should be touching the skin without creating pressure where it touches.
- Remove the collar regularly to check the dog's neck for irritation. We recommend removing the collar when the dog is inside at night. Pressure sores may develop if the collar is too tight or left on for long periods without removal or repositioning.
- Make sure the battery is inserted correctly and is working.

The Training Guide and additional Troubleshooting Tips are available at:

www.dogwatch.com/product-support/

10. TERMS AND CONDITIONS

1. **TERMS AND CONDITIONS OF SALE:** The following terms and conditions apply to all sales of DogWatch® Branded Hidden Fence products by DogWatch Inc. (Company) or Authorized DogWatch Dealer to Customer and supersede all prior discussions, negotiations, and representation between Company, Authorized DogWatch Dealer and Customer.
2. **TWO YEAR LIMITED WARRANTY:** DogWatch Inc., subject to the terms and conditions set forth herein, warrants that for a period of two (2) years from the date of purchase, the Product (transmitter or receiver) will be free from defects in materials and workmanship.
During this warranty period, DogWatch Inc. will, at its sole discretion, repair or replace any defective Product (Transmitter or Receiver) (excluding buried materials). Warranty claims may be subject to Dealer service charges and/or Manufacturer shipping and handling charges. Replacement products will be warranted for the remainder of the original warranty period or six (6) months, whichever is longer.
3. **WARRANTY LIMITATIONS:** The warranty set forth above does not apply to dog chews, normal wear and tear; buried components, including boundary wire; damage caused by misuse, abuse, improper installation, or unauthorized modification (including unauthorized batteries); damage resulting from service or repair by unqualified individuals; damage caused by lightning, power surges, or improper grounding; or the use of non-authorized batteries or accessories.

As a condition of this Warranty:

- (a) Provide proof of purchase or complete the Warranty registration process with DogWatch Inc. within seven (7) days of purchase via online registration at www.dogwatch.com.
- (b) Notify an Authorized DogWatch Dealer or DogWatch Inc. within the Warranty period after the purchase of a claimed defect.
- (c) Mail product back, insurance and postage prepaid, to the Authorized DogWatch Dealer or DogWatch Inc. (10 Michigan Drive, Natick MA 02132)

EXCEPT FOR THE EXPRESS WARRANTY STATED ABOVE, DOGWATCH INC. DISCLAIMS ALL EXPRESS AND IMPLIED WARRANTIES OF MERCHANTABILITY OR FITNESS FOR A PARTICULAR PURPOSE. DOGWATCH INC.'S SOLE LIABILITY UNDER THIS WARRANTY WILL BE TO REPAIR OR REPLACE, AT ITS OPTION, ANY PRODUCT OR PART WHICH DOGWATCH INC. DETERMINES TO BE DEFECTIVE. IN NO EVENT WILL DOGWATCH INC. BE LIABLE FOR ANY SPECIAL, INDIRECT, OR CONSEQUENTIAL DAMAGES ARISING OUT OF THE PURCHASE, INSTALLATION OR USE OF THE PRODUCT. IN NO EVENT SHALL DOGWATCH INC.'S LIABILITY EXCEED THE PURCHASE PRICE OF THE PRODUCT.

10. TERMS AND CONDITIONS

4. **MONEY BACK GUARANTEE:** Original seller (Authorized DogWatch Dealer or DogWatch Inc.) agrees, at its sole cost and expense, to refund full purchase price (less the cost of installation and buried materials) of any DogWatch Branded Hidden Fence product (hereafter the “Product”) sold hereunder within the first 30 days from the date of sale by Company if Customer is not completely satisfied for any reason. Product must be returned in original condition and in the original packaging. Any items returned to us in used condition without packaging will not be credited.
5. **INSTALLATION AND MAINTENANCE:** Customer is solely responsible for the installation of the product and agrees to install it in accordance with DogWatch specifications and instructions. In no event shall DogWatch Inc. or Dealer be responsible for damage to customer property or other utilities, nor shall DogWatch Inc. or Dealer be responsible for restoring Customer’s premises to its original condition. Customer assumes all responsibility and liability for any damage, costs, or losses arising from installation or use of the Product.

WARNINGS:

- ▶ YOU MUST TRAIN YOUR DOG IN ACCORDANCE WITH DOGWATCH'S TRAINING GUIDELINES FOR THIS PRODUCT TO BE EFFECTIVE.
- ▶ THE PRODUCT IS NOT INTENDED FOR USE WITH DOGS WITH A HISTORY OF AGGRESSIVE BEHAVIOR. BY USING THIS PRODUCT, CUSTOMER ACKNOWLEDGES THAT THEIR DOG(S) DO NOT HAVE A KNOWN HISTORY OF AGGRESSIVE BEHAVIOR.
- ▶ THE PRODUCT WILL NOT KEEP ALL DOGS WITHIN THE FENCED PREMISES IN ALL INSTANCES. IF CUSTOMER'S DOG(S) COULD CAUSE HARM TO ITSELF OR OTHERS INSIDE OR OUTSIDE THE FENCED PREMISES, CUSTOMER SHOULD TAKE ADDITIONAL MEASURES TO RESTRAIN THEIR DOG(S).
- ▶ CUSTOMER AGREES TO REMOVE THE COLLAR FROM THE DOG ON A DAILY BASIS TO HELP PREVENT PRESSURE NECROSIS (SKIN IRRITATION OR INJURY). THE COLLAR SHOULD NOT BE WORN CONTINUOUSLY. CUSTOMER IS RESPONSIBLE FOR REGULARLY CHECKING THE DOG'S NECK FOR ANY SIGNS OF REDNESS, IRRITATION, OR DISCOMFORT AND MUST DISCONTINUE USE IMMEDIATELY IF ANY ISSUES ARE OBSERVED.

For more information visit:
www.dogwatch.com

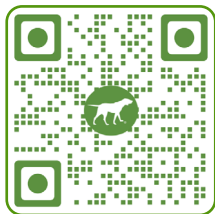

DogWatch, SafeLink, FastReact, and dog logos are registered trademarks of DogWatch Inc.