

**Note:** Any time the magnet activates the receiver, the number of beeps will indicate the current receiver level. As long as the magnet is held in place, it will advance the receiver to the next training level and continue to cycle through the settings in the order shown on the chart below.

TRANSMITTER SETTINGS

**Extended Correction** The Transmitter Extended Correction switch adjusts to three settings: (1 = 5 seconds, 2 = 10 seconds, 3 = 15 seconds). This allows you to customize the correction time on the outside of the boundary wire.

**Training Mode:** The Training Mode Switch allows you to choose between two pet friendly training options: Basic (Mode A) and Simultaneous (Mode B).

- In the Basic (Mode A) setting, your pet receives the normal audible warning followed by a correction if he continues into the signal field.
- When set to Simultaneous (Mode B; used primarily for harder to train dogs), your pet receives an Audible Warning and a Correction at the same time.

NOTE: If you have multiple dogs on the system, the Training Mode setting effects all receivers. They are ALL set to the same mode, Basic or Simultaneous.



RECEIVER TRAINING LEVELS	TRANSMITTER MODE AND EXTENDED CORRECTION SETTINGS			
	Mode A Extended Correction 1	Mode A Extended Correction 2	Mode A Extended Correction 3	Mode B Simultaneous
Audible Only*	+5 seconds	+10 seconds	+15 seconds	Audible
(extra low) 1	+5 seconds	+10 seconds	+15 seconds	Audible & Correction
(low) 2	+5 seconds	+10 seconds	+15 seconds	Audible & Correction
(low medium) 3	+5 seconds	+10 seconds	+15 seconds	Audible & Correction
(medium) 4	+5 seconds	+10 seconds	+15 seconds	Audible & Correction
(medium high) 5	+5 seconds	+10 seconds	+15 seconds	Audible & Correction
(high) 6	+5 seconds	+10 seconds	+15 seconds	Audible & Correction
(extra high) 7	+5 seconds	+10 seconds	+15 seconds	Audible & Correction

\*Level 7 is Simultaneous in all Modes.



} AutoMemory™ self activates and advances to the next level.

\*\*\* IMPORTANT \*\*\*  
Never change the receiver Training Levels when your dog is wearing the collar.

10 Michigan Drive  
Natick MA 01760  
800-793-3436



For more information visit:  
[www.dogwatch.com](http://www.dogwatch.com)

Operating Instructions  
R10 Receiver

## R10 Receiver

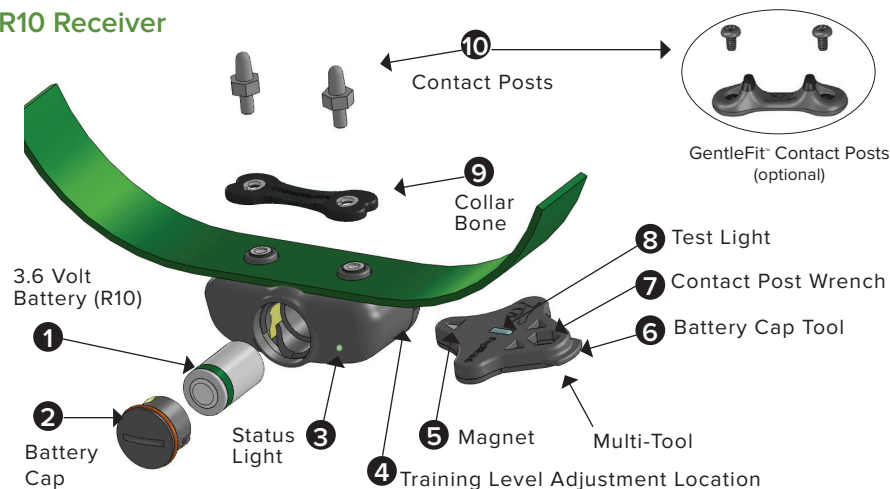

The components of both the R10 (above)

## Receiver Battery

The R10 uses a replaceable battery. The receiver is waterproof when the battery cap is fully seated.

**R10 Battery:** The R10 receiver uses a 3.6 volt lithium battery. With normal use, battery life should be about 9 months for the R10. The positive (+) end of the battery must be inserted down.

## Resetting the Battery Status Light

1. Remove the old battery.
2. Let the receiver sit for several minutes before inserting a new battery. If you forget to wait prior to inserting a new battery, the flashing red battery status light will continue to flash for 24 hours before automatically resetting.
3. Insert a new battery.

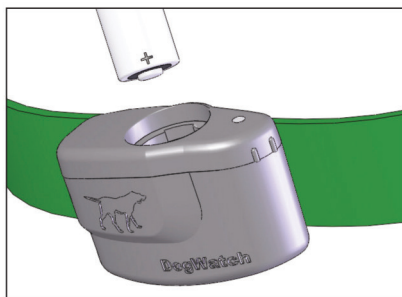

Insert R10 battery **POSITIVE** end down.

## Setting the Receiver

**Receiver Training Levels** Your receiver provides eight training levels that allow you to customize the training setting to your dog's individual needs: Audible Only, Level 1 (extra low), Level 2 (low), Level 3 (low medium), Level 4 (medium), Level 5 (medium high), Level 6 (high), and Level 7 (extra high). When the receiver is shipped from the manufacturer, it is set to Training Level 2 (low).

**Changing the Receiver Settings** If you need to change the Training Level on the receiver, hold your test light magnet to the marked area on the side of the receiver. Hold the magnet steady and you will hear a series of beeps that indicate the current training level. The "Audible Only" level is one long beep, Level 1 is one short beep, Level 2 is two short beeps, Level 3 is three short beeps, etc. The Training Level will continue to advance while the magnet is held in position. When you reach the desired setting, pull the magnet away from the receiver. The receiver is now set.

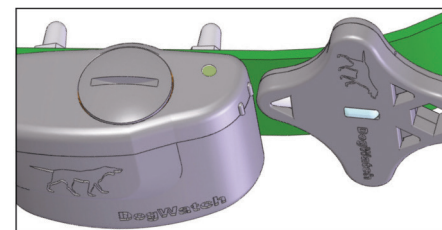

Using the magnet to set the training level on the R10 Receiver.

## Receiver Features

### Status Lights

- **Start-Up** When you first insert the battery into your receiver, the status light will flash red and green. This indicates that the receiver has started properly. Once started, the status light will continue to flash green once every 40 seconds indicating normal operation. In the event that the light does not flash, check the battery to be sure that it has been inserted properly.
- **Training Level Indicator** When programming the training level of your receiver, the status light will flash green in conjunction with audible beeps. The number of flashes will equal the training level you have chosen.
- **Signal Field Indicator** When testing the receiver in the signal field the status light will flash green when the receiver is in the warning zone and will flash green and red when the receiver is in the correction zone.
- **Correction Alert (TattleTale™)** You will be able to tell if your pet has entered the correction area by looking at the status light. The status light will double flash green every 40 seconds for 24-hours after the dog enters the boundary area.
- **Battery Indicator** This feature monitors the voltage level of the battery. When the receiver detects that the battery has reached a low voltage level, the status light will change from the normal blinking "green" every 40 seconds to blinking "red" every 10 seconds. This indicates that your battery is close to the end of its useful life and you should change the battery within the next 3-4 days.

**AutoMemory™** When the receiver is set to Level 4, 5, or 6, our AutoMemory feature automatically raises the correction level of the receiver if your pet enters the avoidance zone. If the dog does not enter the signal field again in the next 24-hour period, the receiver defaults to the original setting.