

# DogWatch®

## Hidden Fences

### Operating Instructions for DogWatch® System 1200

.....



R12 Receiver

R12m Receiver

## DOGWATCH HIDDEN FENCES

10 Michigan Drive ■ Natick, MA 01760 ■ **800-793-3436** ■ [www.dogwatch.com](http://www.dogwatch.com)

## R12 and R12m Receiver

The components of both the R12 (above) and the R12m are the same except the R12m is smaller and uses a different battery.

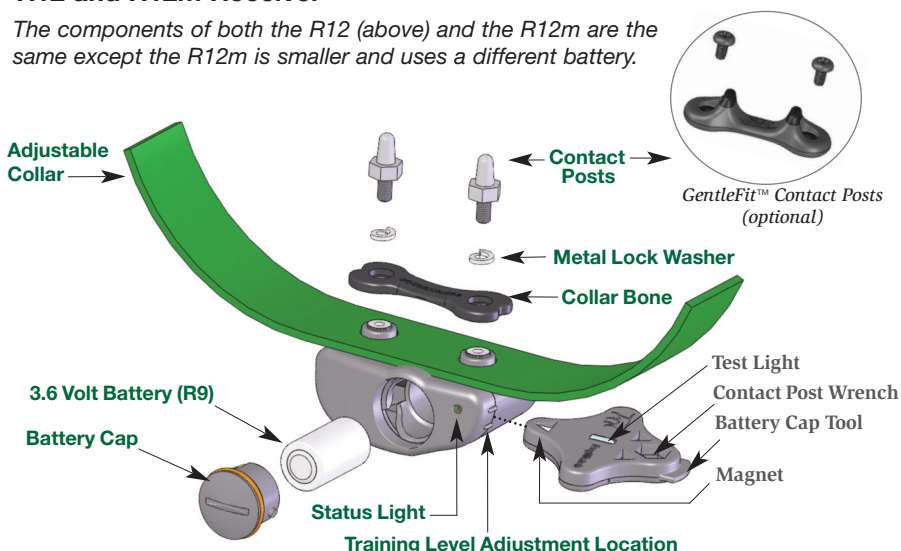

## Receiver Battery

Both the R12 and the R12m operate on a replaceable battery. Both receivers are waterproof when the battery cap is fully seated.

**R12 Battery:** The R12 receiver is powered by a 3.6 volt lithium battery. With normal use, the battery should last about **two years**. The positive (+) end of the battery must be inserted down. (Figure 1)

**R12m Battery:** The R12m receiver is powered by a 3 volt (1/3 N) lithium battery. With normal use, the battery should last about **six months**. The negative (-) end of the battery must be inserted down. (Figure 2)

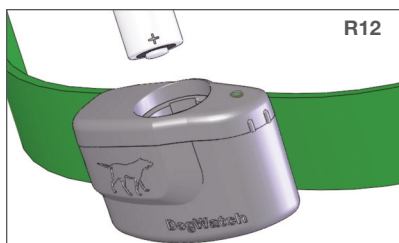

Insert battery **POSITIVE** end down.

Figure 1

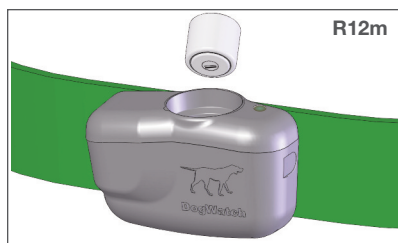

Insert battery **NEGATIVE** end down.

Figure 2

**Battery Plans:** Ask your DogWatch Dealer about a battery plan. If your DogWatch Dealer does not offer a battery plan, you can join the DogWatch Battery Program, where a new battery is mailed to you every 6 or 24 months, depending on the type of receiver you own. Call DogWatch at 800-793-3436 or join through the website at [www.dogwatch.com](http://www.dogwatch.com).

## SYSTEM 1200 RECEIVER FEATURES

**Adjustable Collar:** The receiver is attached to an adjustable nylon collar. The collar should be positioned above the dog's regular collar. Adjust the collar to insure that the contact posts touch the skin on the dog's neck. (Figure 3) *Check the fit for the first few days of wear to insure that the collar is not too tight or causing irritation to your pet's neck.* It is recommended that you remove the collar at night while your pet is inside.

Figure 3

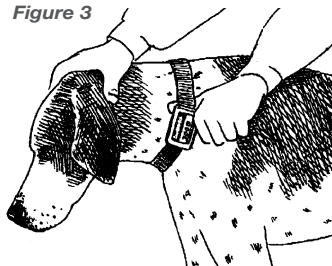

**Contact Posts:** Your DogWatch Dealer will determine the correct size and type of contact posts based on your dog's neck shape, coat, and skin sensitivity. The posts must make contact with the skin in order for the dog to feel the stimulation. In certain cases, it may be helpful to clip some of the hair around the contact posts.

*Tighten the contact posts only with the collar wrench provided. Use of pliers or similar tools can result in over-tightening, which can damage the receiver.*

**Antenna:** The receiver incorporates an omni-directional antenna design. The use of multiple antennas in the receiver assures optimal reception from the signal field.

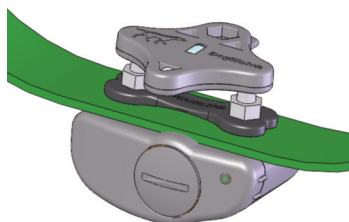

Figure 4

**Test Light:** The test light allows you to test the receiver. Hold the test light over the contact posts. (Figure 4) and carry the receiver into the signal field. When the receiver picks up the signal from the boundary wire, the audible warning will sound and the test light will come on.

**Automatic Shutdown:** The DogWatch System is designed to protect your dog from an over-correction in the unlikely event that your dog walks into the signal field. If your dog does not exit the signal field, the receiver will automatically stop correcting after 15 seconds to protect your dog from over-correction. The dog will also receive a "warning" correction every 15 seconds which will continue until he leaves the field.

## Receiver Settings / Training Levels

System 1200 incorporates 4 training levels plus an audible only setting. Level 1 is a very low correction setting that in many cases is an appropriate training level for timid pets. Levels 2 and 3 are progressively stronger training levels. Level 4 is designed specifically for pets that require higher correction levels in order to be contained. Your DogWatch Dealer will set the receiver to the appropriate training level for your pet.

All settings are designed to be **Pet Friendly™** and will not harm your dog.

## Setting and Changing the Training Level

Hold the test light with the magnet end at the marks on the side of the receiver (as shown on page 3). Hold the magnet steady and **you will hear a series of beeps as the Training Level advances.** The Training Level will continue to advance as long as the magnet is held in position.

Setting and Changing the Training Level (cont.)

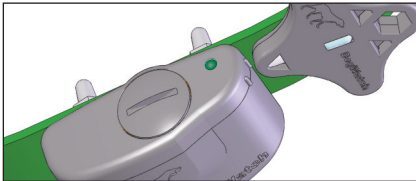

R12 Receiver

Hold the magnet between the two lines on the side of the receiver to reset the training level.

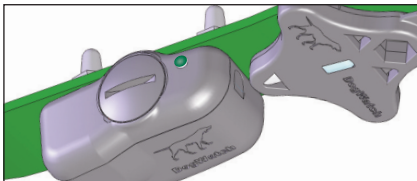

R12m Receiver

Hold the magnet at the marked area on the side of the receiver to reset the training level.

When you reach the desired Training Level, pull the magnet away from the receiver. The receiver is now set. Note: Any time the magnet activates the receiver, it will advance the receiver setting to the *next* Training Level, and continue to cycle through the settings in the order shown in the table below, as long as the magnet is held in place.

NOTE: Any magnet directed at the marks on the side of the receiver will activate this process.

Training Level	Audible Only	Level 1	Level 2	Level 3	Level 4
Tone	One Long Beep	1 beep	2 beeps	3 beeps	4 beeps
Correction Level	None	Low	Medium	Medium -High	High

**Multiple Dogs** The System 1200 allows you to select a different training level for each dog – allowing you to conduct training with one dog, for example on Level 1, while the other dog is protected with Level 2.

Receiver Status Light

The status light continuously monitors your receiver and provides these features.

- **Start-Up** When you first insert the battery into your receiver, the status light will **flash red and green**. This indicates that the receiver has started properly. Once started, the status light will continue to **flash green** once every 40 seconds indicating **normal operation**. In the event that the light does not flash, check the battery to be sure that it has been inserted properly.
- **Training Level Indicator** When programming the training level of your receiver (see page 8), the status light will **flash green** in conjunction with audible beeps. The number of flashes/beeps will equal the training level you have chosen.
- **Signal Field Indicator** When testing the receiver in the signal field, the status light will **flash green** when the receiver is in the audible zone and will **flash red and green** when the receiver is in the correction zone.

(cont. next page)



The R12m Status Light



The R12 Status Light

## Receiver Status Light (cont.)

• **Battery Indicator** This feature monitors the voltage level of the battery. Once the receiver detects that the battery has reached a low voltage level, the status light will change from the normal **blinking green** every 40 seconds to **blinking red** every 10 seconds. This indicates that your battery is close to the end of its useful life and you should change the battery within the next 3-4 days.

## Resetting the Low Battery Light

1. Remove the old battery.
2. Before inserting a new battery, **let the receiver sit for five minutes** with no battery.
3. After five minutes, insert the new battery.

*If you forget to wait prior to inserting a new battery, the "low battery" light will continue to blink red until it automatically resets itself after 24 hours.*

---

## SYSTEM 1200 TRANSMITTER FEATURES

Range +/-: The radio signal is transmitted from the boundary wire in all directions. The signal is adjusted by the range control on the transmitter to create a signal field on each side of the wire. Your DogWatch Dealer will adjust the range accordingly. The range control is very sensitive.

DogWatch System 1200 Transmitter

If you adjust the signal range on the transmitter, be sure you check the signal range in the yard before letting your dog out. Your dog will need to learn where the new avoidance zone begins.

Never adjust the signal range when your dog is wearing the receiver collar.

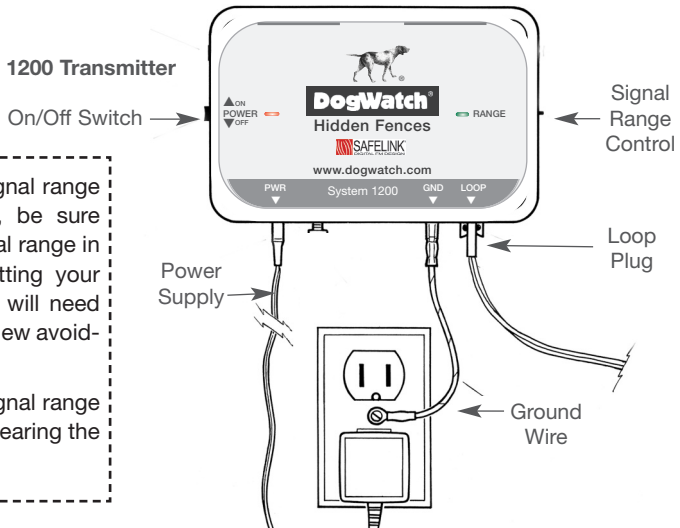

## CONTAINMENT TRAINING

This section provides general guidelines for training your dog to remain within the designated boundary of your property. Your DogWatch Dealer will customize the training for your dog and teach you the appropriate training approach.

Your DogWatch Dealer will install your DogWatch Hidden Fence System, set the transmitter and receiver to the training levels appropriate for your dog's personality, and will place boundary flags around the perimeter of your yard. After installing the system, your Dealer will prepare you and your dog for the training process.

### Safe and Avoidance Zones

*Think of the property having two distinct zones:*

#### 1. SAFE ZONE:

The Safe Zone is the area where the dog is free to play. (Figure 5)

#### 2. AVOIDANCE ZONE:

The Avoidance Zone is the area **between** the flags and the boundary wire where there is a signal created by the wire. When your dog crosses into the signal field, the receiver collar emits an **audible warning**. If your dog continues to move toward the boundary wire after hearing the warning beeps, he will receive a correction. After training, your dog will remain in the Safe Zone.

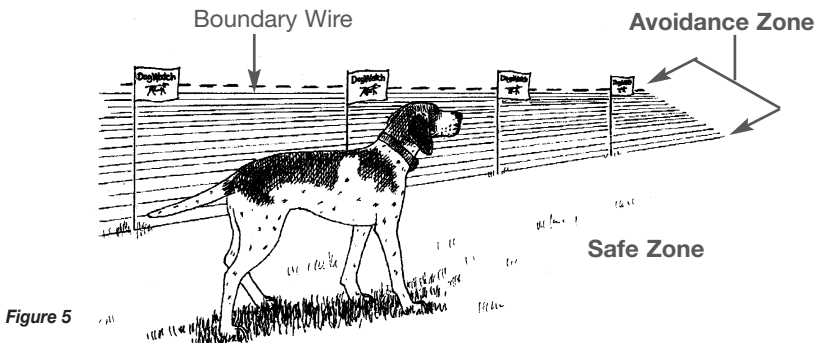

### Creating The Right Environment

*Attitude and Consistency is Important!*

1. Keep the training "light". Use lots of praise. Keep the dog's spirits high.
2. Use high happy tones for praise. Use low tones for negative commands.
3. Move around the boundary in the same direction.
4. Reinforce the boundary with commands. Use the commands "Watch Out!" or "Careful" as you slap or shake the flags.
5. Limit the training session to no more than 20 minutes.
6. Keep your dog on the lead in the yard for five days.
7. If you are training more than one dog, train each dog separately.
8. Use naturally occurring distractions such as a neighbor or children.
9. Contact your DogWatch Dealer if you have any questions.

## Adjusting The Receiver

*Before you begin containment training, be sure to place the DogWatch receiver collar on your dog's neck before you go outside.*

1. The collar should be worn snugly on the dog's neck. This is extremely important!
2. Place no more than one thumb width between the contact post and dog's neck.
3. When checking snugness of the collar, the dog's neck should be facing down (sniffing position) as this is where the dog's neck is the smallest. (Figure 6)
4. If the collar is too tight, the receiver unit will stick out to the side when the dog shakes his head.
5. If the collar is too loose, the dog will not receive the intended correction when he or she wanders into the Avoidance Zone. (Figure 7)
6. Remember to periodically check for irritation around the dog's neck.
7. DogWatch strongly recommends that the collar be removed daily when the dog is inside the house.



Figure 6

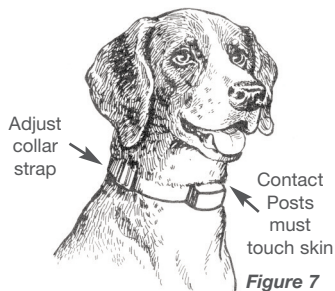

Figure 7

## General Training Approach

*Purpose: To teach your dog where the boundary is and how to react to it.*

1. Only a portion of the yard, the Avoidance Zone, is to be avoided.
2. **Playtime is very important!**  
Remember to reinforce the Safe Zone and play with your dog before, during, and after each training sessions. (Figure 8)
3. Never throw a ball or toy into the Avoidance Zone (especially during training!)
4. Your DogWatch Dealer will determine the most appropriate training approach for your dog. It is important to work with your Dealer to insure you understand the training plan.

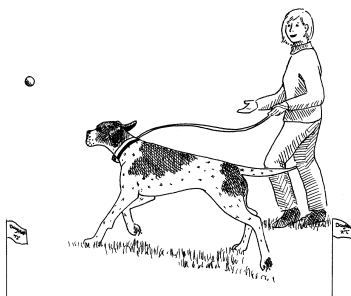

Figure 8

The remainder of this section describes general training Phases. Your Dealer may modify the approach described in this manual in order to meet the specific training needs of your dog. There are many successful training approaches that may be used.

If you have questions about containment training, please contact your DogWatch Dealer for assistance.



## PHASE 1 (1-2 days)

### Audible or “Beep” Training

During this phase, your DogWatch Dealer will set your dog's receiver to “audible only”. In this mode, only the audible “beep” will be heard when your dog enters the Avoidance Zone. In this mode, your dog cannot receive a correction.

1. Put the receiver collar on your dog 20 minutes before training. Your dog's regular collar should be positioned below the DogWatch collar.
2. Clip your dog's leash onto his regular collar.
3. Take your dog outside and play with him in the Safe Zone for a few minutes.
4. Walk your dog around the perimeter of your yard, keeping inside the Safe Zone and about 3 to 4 feet away from the training flags.
5. When you finish the walk, approach a training flag. Hold the dog by the leash in one hand and slap or shake a flag with the other, warning the dog firmly (in a low stern voice) “Watch out! or “Careful!” (Figure 9) You can also have a friend or family member sit in the Avoidance Zone to slap or wave the flag as you approach it.
6. Give a ‘leash correction’ (a quick, firm tug) and quickly retreat into the Safe Zone. This creates a sense of urgency to the retreat. It is not a casual turn. Remember to use of lot of “Good dog!” praise after you've retreated into the Safe Zone.
7. Now walk your dog around the property allowing him to enter the Avoidance Zone between the two flags.
8. When your dog enters the Avoidance Zone, he will receive an audible “beep” warning. Immediately say firmly and sternly, “Watch out!” while giving a quick tug on the leash to direct him back into the Safe Zone. Praise him for returning to the Safe Zone. (Figure 10)
9. Repeat several times in different locations (where flags are visible) and watch for hesitation as you approach the flags. Your dog may turn or shake his head when he hears the beep.



Figure 9

### Remember:

Playtime is very important!

Praise and play with your dog in the Safe Zone for a few minutes. Take your dog inside and remove the DogWatch receiver collar after about 20 minutes. Train your dog in this manner for a least two days before moving onto Phase 2.

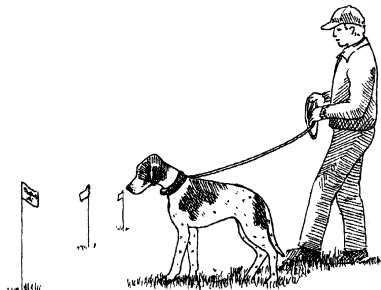

Figure 10

## PHASE 2 (2-5 days)

### Introduction to Correction

1. Put the DogWatch receiver collar on your dog at least 20 minutes before going outside to train.
2. With the leash on, take your dog outside and play a few minutes in the Safe Zone.
3. Walk around the complete perimeter, remaining inside the Safe Zone. Pause a few times along the way to slap a flag, firmly saying, "Watch out!" or "Careful!"
4. Select a new location to teach your dog today. Allow your dog to walk into the Avoidance Zone while saying the negative command. If your dog retreats out of the Avoidance Zone when he hears the warning "beep", praise him for a few minutes in the Safe Zone.
5. Select another location and repeat the exercise. Continue training up to (no longer than) 20 minutes once or twice a day.
6. After training, praise your dog and play with him in the Safe Zone for a few minutes, bring your dog into the house and remove the DogWatch collar after about 20 minutes.

**Note:** It is important **not** to remove the receiver collar immediately following the training as you do not want your dog to associate the receiver collar with the correction.

## PHASE 3 (2-5 days)

### Introduction to Distractions

1. Put the DogWatch receiver collar on your dog at least 20 minutes before going outside to train.
2. With the leash on, take your dog outside and play a few minutes in the Safe Zone.
3. Walk around the Safe Zone and have an assistant (friend or family member) appear outside the Safe Zone at least 10 to 15 feet back from the flags. Walk past your assistant without speaking, but remain in the Safety Zone. (Figure 11)
4. If your dog approaches your assistant and enters the Avoidance Zone, allow your dog to receive a correction. In a firm, stern voice, say "Watch out!" and tug him back into the Safe Zone.
5. Let your assistant leave, walk your dog around the perimeter again, and let your assistant appear again. Your assistant can call out the dog's name, but do not allow your assistant to ask the dog to "Come".
6. If your dog attempts to go over to your assistant, reinforce the flags ("Watch out!") Repeat the exercise in other locations for no more than a total of 20 minutes.
7. If your dog makes no attempt to go over to your assistant, reinforce the flags, end the exercise and praise your dog in the Safe Zone.
8. Repeat the exercise for 2 to 5 days. Then move to Phase 4.

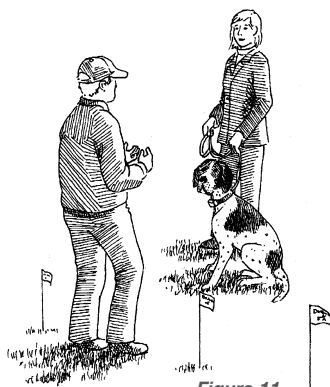

Figure 11

## PHASE 4 (2-5 days)

### Introduction to Increased Distractions

1. Put the DogWatch receiver collar on your dog at least 20 minutes before going outside to train.
2. With the leash on, take your dog outside to play a few minutes in the Safe Zone.
3. Reinforce the flags.
4. Introduce “real life” distractions to your dog. Have a friend drop by or start training when the letter carrier or school bus is scheduled. *Take extra care if you use a vehicle as a distraction. (Figure 12)*
5. Keep the leash on your dog when you first introduce the distraction. If your dog attempts to run past the flags and receives a correction, he should retreat to the Safe Zone. Praise and play with your dog.
6. If your dog is afraid to move, tug him back into the Safe Zone. Continue to train with distractions for 2 to 5 days.

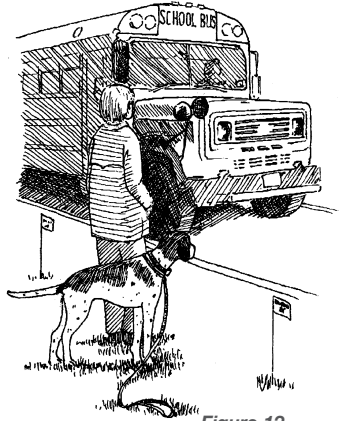

Figure 12

**Remember:** Play and praise at the end of each training session.

## PHASE 5 (2-5 days)

### Letting Your Dog Off The Leash

1. Put the DogWatch receiver collar on your dog at least 20 minutes before going outside to train.
2. With the leash on, take your dog out to play a few minutes in the Safe Zone. Remove the leash and let him run freely in the yard. Shake the flags to reinforce where the safe zone boundary.
3. Important: Your dog will expand his comfort level over a period of time. Your dog should remain about 6 feet away from the flags when he is first let off the leash. Gradually your dog's Safe Zone will increase to his individual level of comfort.
4. When your dog is comfortable playing in the Safe Zone and respects the Safe Zone boundary, begin removing the flags. ***Remove every other flag, every other day until all the flags are removed.***

### What To Expect Off Leash

1. Your dog will run toward the flags, see them and stop.
2. Your dog will run into the system, hear the “beep” warning and retreat.
3. Your dog will run into the system, hear the “beep” warning, receive a correction, and retreat.

## Training Tips

1. Never call your dog to “come” or give a recall command when you are outside the flag line.
2. Never walk through the flags to take your dog for a walk outside the system during the training process. Carry him or drive over the boundary area.
3. Always reinforce the retreat concept by shaking the flag while saying “Watch out!” and commanding “back-back-back-” when your dog receives an audible warning or a correction during the training process.

## Troubleshooting Questions

### **Question:**

*My dog is afraid to come off the porch after a day or two of training. What should I do?*

### **Answer:**

Walk your dog around the boundary so he knows where the Safe Zone is. Don't force your dog to go up to the flags if he hesitates. Each day he'll get closer to the boundary line and flags. When he goes closer to the flags, slap the flag and yell. “Watch out!” Retreat to the Safe Zone and praise and play.

### **Question:**

*My dog will not come out of the house. I don't want to drag him outside. What can I do?*

### **Answer:**

Refrain from training today. Take your dog outside and play with him in the yard until he feels comfortable again. Resume training in a day or two.

Contact your DogWatch Dealer if you need assistance or if you have any questions about the training or your dog's behavior.

## **Important Reminders:**

- Adjust the receiver collar and test the battery regularly.
- **Remove the collar at night.** Check your dog's neck area regularly to make sure there is no irritation.
- Keep the training consistent: 15 to 20 minutes once or twice a day.
- Keep the contact posts clean.
- NEVER throw a stick or toy into the Avoidance Zone.
- ALWAYS maintain a positive attitude when training your dog.
- NEVER allow your dog to cross the boundary.

## **Your Dog's Response To Stimulation**

Stimulation has been a safe and effective part of dog training for over twenty years. All dogs respond differently when they feel a mild stimulation. Some dogs may demonstrate little, if any, reaction, while others may yelp or jump back. Some dogs “freeze”. Do not try to comfort the dog if he receives correction or it will reinforce his anxiety.

## **Dog Personalities and Traits**

Your DogWatch Dealer will ask you questions about your dog before training begins. The information you provide will help your Dealer customize the training for your dog's breed and personality. Keep in mind that a dog's personality and traits differ among breeds and also within the same breed.

The better you know your dog, the easier the training will be for both of you!

4. In rare cases, your dog will run through the boundary.

- Retrieve the dog. Take off the receiver collar and walk him back into the yard.
- Bring the dog into the house and call your DogWatch Dealer. Additional flag training or an increase in correction level is necessary. Your DogWatch Dealer will instruct you over the phone or meet with you and your dog for additional training.

**Important:** Do not punish the dog for making errors. He's still learning!

## PHASE 6 (2-5 days)

### **Taking Your Dog Outside The Boundary**

Your Dealer will recommend when it is time to take your dog across the boundary for a walk. It is important to be consistent when taking your dog for a walk. Be sure to use your dog's regular collar and leash and go to and from your walk using the same "exit" area. You can also pick up a small dog and carry him over the flagged boundary during the first weeks of training.

### **Training Tips**

1. Never call your dog to "come" or give a recall command when you are outside the flag line.
2. Never walk your dog through the flags during the training process.
3. Always reinforce the retreat concept by shaking the flag while saying "Watch out!" and commanding "back-back-back-" when your dog receives an audible warning or a correction during the training process.
4. Adjust the receiver collar, test the battery regularly, keep the contact posts clean.
5. After the training period, your dog may wear the receiver collar during the day, but remove it at night. Check your dog's neck area and make sure there is no irritation.
6. Keep the training consistent: 15 to 20 minutes once or twice a day.
7. NEVER throw a stick or toy into the Avoidance Zone.
8. ALWAYS maintain a positive attitude when training your dog.

## IMPORTANT SAFEGUARDS

### \*\*\* IMPORTANT \*\*\*

DOGWATCH STRONGLY RECOMMENDS THAT YOU  
REMOVE THE COLLAR AT NIGHT WHILE THE DOG IS INSIDE.

- Please read all the literature included with your DogWatch® Hidden Fence System before turning the system “on” or beginning training.
- Do not attempt to shortcut the complete training of your dog.
- The DogWatch Hidden Fence System is intended for the purpose of containing domestic dogs. Using it for any other purpose is at the system owner’s risk.
- In the event your system requires servicing, please contact your local Authorized DogWatch Dealer. Attempting to service the system yourself may invalidate the warranty.

**To contact your local Dealer, please call DogWatch Inc. Customer Service at: 800-793-3436 or go to our Web Site at [www.dogwatch.com](http://www.dogwatch.com) and click on “Locate Dealer.”**

- Keep the transmitter and receiver collar out of reach of children.
- Fit the collar snugly around your dog’s neck.
- Never adjust the transmitter when your dog is wearing the collar
- Although System 1200 contains built-in protective circuitry to reduce damage from a lightning storm or power surges, it is recommended that you unplug your transmitter from the wall outlet and disconnect the loop wire during lightning storms, or when it is unused for extended periods.
- This product is only intended for with trained domestic dogs. If your dog is aggressive or violent and could cause harm to itself or others outside the fenced premises, you should take other measures to restrain your dog such as traditional fencing.

## Warranty Registration

Your Warranty Registration card must be complete for your warranty to be activated. Fill out the enclosed Warranty Registration card and mail back to DogWatch within seven (7) days. For your convenience, you can also complete your warranty registration on line at [www.dogwatch.com](http://www.dogwatch.com).

## Manufacturer's Warranty

1. WARRANTY: DogWatch Inc., subject to the terms and conditions set forth hereunder, hereby warrants that it will repair or replace, at its own discretion, without charge for parts or labor, the Product or any part thereof (other than insulated wire) which is found by DogWatch Inc. to be defective by reason of improper workmanship and/or materials for the warranty period from the original date of sale hereunder. Warranty claims may be subject to Dealer service charges and/or manufacturer shipping and handling charges. EXCEPT FOR THE EXPRESS WARRANTY STATED ABOVE, DOGWATCH INC. DISCLAIMS ALL EXPRESS AND IMPLIED WARRANTIES OR MERCHANTABILITY OR FITNESS FOR A PARTICULAR PURPOSE. As a condition of this warranty, Customer must (a) mail the warranty card provided with the product to DogWatch Inc, 10 Michigan Drive, Natick, MA 01760, (800) 793-3436, or complete warranty registration on line at [www.dogwatch.com](http://www.dogwatch.com), within seven (7) days after purchase hereunder, (b) notify DogWatch Inc. within the warranty period after the purchase hereunder of a claimed defect, and (c) mail product back, insurance and postage prepaid, to DogWatch Inc. at the address above. DOGWATCH INC.'S SOLE LIABILITY UNDER THIS WARRANTY WILL BE TO REPAIR OR REPLACE, AT ITS OPTION, ANY PRODUCT OR PART WHICH DOGWATCH INC. DETERMINES TO BE DEFECTIVE. IN NO EVENT WILL DOGWATCH INC. BE LIABLE FOR ANY SPECIAL, INDIRECT, OR CONSEQUENTIAL DAMAGES ARISING OUT OF THE PURCHASE OR USE OF THE PRODUCT. IN NO EVENT SHALL DOGWATCH INC.'S LIABILITY EXCEED THE PURCHASE PRICE OF THE PRODUCT.

2. DEALER-INSTALLED WARRANTY: Any transmitter installed by an authorized Dealer, equipped with a DogWatch Lightning Surge Protector and grounded to Dogwatch Inc. specifications, will be warranted for as long as the owner owns the system. Both the R-12 and R12m receiver carry a lifetime warranty. For this additional coverage to be in effect, the installing Dealer and Customer must sign the Customer Order Form and forward it to DogWatch within seven (7) days of purchase.

3. INSTALLATION AND MAINTENANCE: Dealer shall, for a non-refundable installation fee, install the Product in accordance with DogWatch Inc.'s installation manual. In no event shall Dealer or DogWatch Inc. be responsible for damage to underground pipes, wires, lines, or other items, nor shall Dealer or DogWatch Inc. be responsible for restoring Customer's premises to its original condition.

### 4. WARNINGS:

- YOU MUST TRAIN YOUR DOG IN ACCORDANCE WITH YOUR DEALER'S INSTRUCTIONS FOR THIS SYSTEM TO BE EFFECTIVE.
- THE SYSTEM IS NOT INTENDED FOR USE WITH DOGS WITH A HISTORY OF AGGRESSIVE BEHAVIOR. BY SIGNING THE DEALER ORDER FORM, CUSTOMER ACKNOWLEDGES THAT THEIR DOG(S) HAVE NO SUCH HISTORY.
- THE PRODUCT WILL NOT KEEP ALL DOGS WITHIN THE FENCED PREMISES IN ALL INSTANCES. IF CUSTOMER'S DOG(S) COULD CAUSE HARM TO ITSELF OR OTHERS INSIDE OR OUTSIDE THE FENCED PREMISES, CUSTOMER SHOULD TAKE ADDITIONAL MEASURES TO RESTRAIN THE DOG(S).

DogWatch, DogWatch logos, Performance Series, and SafeLink are registered trademarks of DogWatch Inc.

DogWatch products are protected under U.S. Patent numbers:  
5,353,744; 5,465,687; 6,079,367; 6,360,698; 6,467,435; 6,575,120; 6,825,768 and D,491,481.

This device complies with part 15 of the FCC Rules. Operation is subject to the following two conditions: (1) This device may not cause harmful interference, and (2) this device must accept any interference received, including interference that may cause undesired operation.

DogWatch products are lead-free and compliant with the  
Reduction of Hazardous Substances (RoHS) initiative.

©2013 DogWatch Inc. All rights reserved. 295025 Rev. G 11-2013



**DogWatch®**

**Hidden Fences**

10 Michigan Drive ■ Natick, MA 01760 ■ **800-793-3436** ■ [www.dogwatch.com](http://www.dogwatch.com)